



CONNEX 2 MDT800 Quick Start Guide



BrainBee®
WORKSHOP SOLUTIONS

Main components

1 USB 2.0 connector

2 Combo audio connector

3 Micro SD card slot

4 USB 3.2 Gen 1 Type-C

5 Handle

6 Camera lens

7 Microphone

8 Light sensor

9 Brightness up

10 Brightness down

11 Volume up

12 Volume down

13 Power button

14 Speaker

15 Indicators

16 Touchscreen

17 Power connector

18 Kensington lock

19 Battery pack

20 Stylus

21 Docking connector

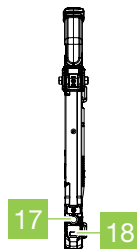
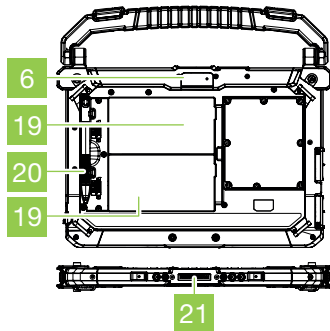
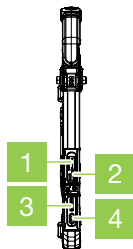
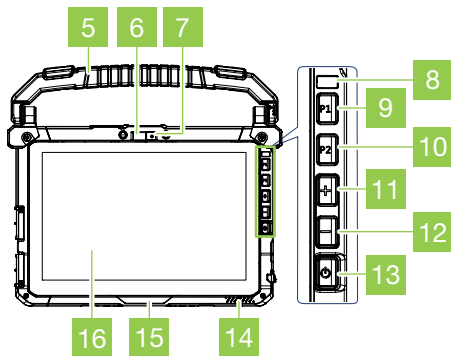

INSTALLING THE BATTERY

1. Install the battery packs

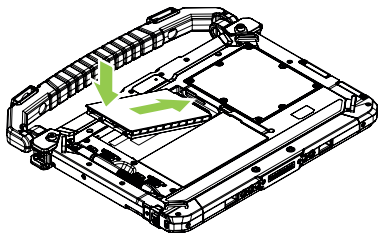

2. Lock the battery packs

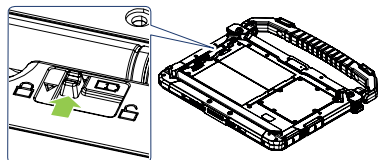

CHARGING THE BATTERY

1. Connect the AC adapter to charge the battery

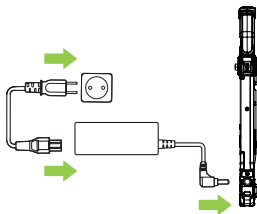

Use only the charger supplied by the manufacturer.



Do not charge/discharge or place the battery in high-temperature locations.

INITIAL STARTUP

1. Press the power button for 3 seconds

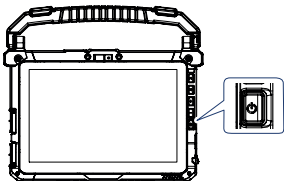

2. Follow the screen instructions

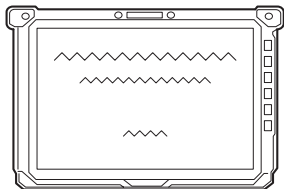

Please refer to the
CONNEX 2 MDT800
manual for the actual use
of the device.



This card is a “Quick Guide”
and is not intended to replace
an instruction manual.
For further information, EU
Declaration of Conformity or
more detailed instructions,
please refer to the user manual
using the QR Code shown.





www.brainbee.mahle.com
www.mpulse.mahle.com

This Quick Guide is available
in additional languages: scan
QR Code to download them

