

IT SIMPLY WORKS.

2019.Q2 (15.06.19)

NEWS AND ANTICIPATIONS DIAGNOSTIC DATABASE

Over **660** New Systems Released



TOP5 TOPICS

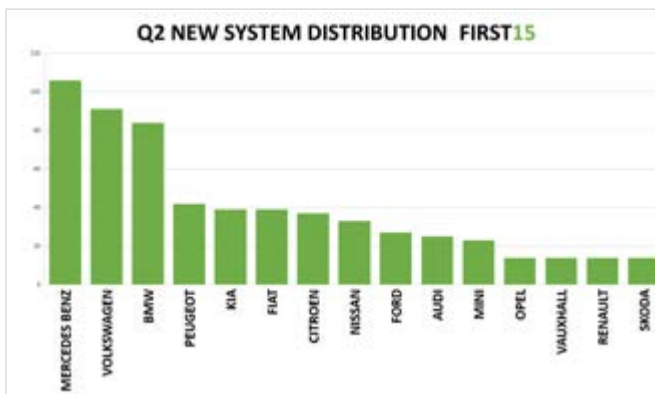

- // **BMW: SERVICE** PG. 13
- // **FORD: EDI | EFI** PG. 13
- // **KIA** PG. 14
RIO | PICANTO
- // **MASERATI: SERVICE** PG. 14
- // **HYBRID ELECTRIC VEHICLES** PG. 16 | 17
VOLVO V60 | PEUGEOT 508



CONNEX DIGITAL @DAS

THE
ORIGINAL
REVOLUTIONARY
SYSTEM

CALIBRATION CAN BE COMPLETED IN JUST 6 STEPS

1. IN CONNEX, SELECT MAKER - CAR MODEL. THEN SELECT "DIGITAL ADAS": THE ON-LINE HELP POPS UP, WITH INSTRUCTIONS ON HOW THE CAR SHOULD BE POSITIONED.



2. PLACE THE WHEEL CLAMPS ON THE FRONT WHEELS, AS INDICATED IN THE ON-LINE HELP INSTRUCTIONS.



3. PLACE THE DIGITAL TARGET CLOSE TO THE CAR: THE SPECIAL SUPPORT FRAME MAKES HANDLING EXTREMELY EASY.



4. ENTER THE REQUIRED VALUES, USING THE TWO LASER DISTANCE METERS. THESE ARE THE PARAMETERS REQUIRED TO EXECUTE THE KEYSTONE FUNCTION.

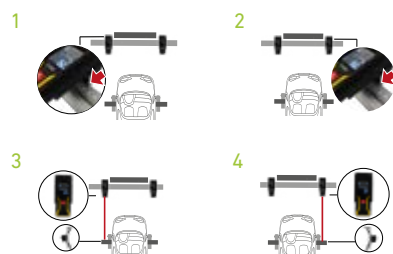

5. ADJUST THE HEIGHT AS INDICATED IN THE ON-LINE HELP INSTRUCTIONS. IT IS VERY SIMPLE AND EASY VIA THE REMOTE CONTROL AND THE MOTORIZED SLIDING CARRIAGE.



6. THE CALIBRATION STARTS. THE MONITOR WILL SHOW THE TARGET, ADAPTING IT TO THE CAR POSITION, AND THEREFORE ENSURING THE MOST ACCURATE RESULT.



WHY YOU SHOULD CHOOSE BRAIN BEE DIGITAL @DAS



TARGETLESS TECHNOLOGY

It's MAHLE patented *targetless* technology, the core element of the system. The versatility of the digital panel allows adapting the screen to any existing or future car makers reference protocol.



EASY TO USE

It is so simple to use that you won't waste any time trying to learn or just using it: the system will guide you through all the steps of the calibration procedure.



FULLY AUTOMATIC

The calibration frame is adjusted automatically, through the electric control, and any movement of the target, in relation to the car, is automatic and virtual. The car never moves!



KEYSTONE SYSTEM

Extreme accuracy is guaranteed by the self-adaptive system, which allows the software to evaluate the environmental and physical conditions (floor, distance from vehicle) and adapt the digital target image accordingly.



UNIVERSAL COVERAGE

Ensuring the largest market coverage is very important to us. The database that's behind the operation of DIGITAL @DAS follows the constant development of CONNEX self-diagnosis.

2019.Q2 15.06.2019

NEWS AND ANTICIPATIONS

DIAGNOSTIC DATABASE



//@DAS - DIGITAL TECHNOLOGY

ALFA ROMEO

GIULIA [2016] (952)	STATIC FRONT CAMERA CALIBRATION (STATIONARY VEHICLE WITH TARGET)
	STATIC FRONT RADAR CALIBRATION (STATIONARY VEHICLE WITH MIRROR)
STELVIO [2016] (949)	STATIC FRONT CAMERA CALIBRATION (STATIONARY VEHICLE WITH TARGET)
	STATIC FRONT RADAR CALIBRATION (STATIONARY VEHICLE WITH MIRROR)

AUDI

A3 [2012] (8V)	STATIC FRONT CAMERA CALIBRATION (STATIONARY VEHICLE WITH TARGET)	
	STATIC FRONT RADAR CALIBRATION (STATIONARY VEHICLE WITH MIRROR)	NEW
A4 [2015] (F4)	STATIC FRONT CAMERA CALIBRATION (STATIONARY VEHICLE WITH TARGET)	
A5 [2016] (F5)	STATIC FRONT CAMERA CALIBRATION (STATIONARY VEHICLE WITH TARGET)	
A6 [2011] (4G)	STATIC FRONT CAMERA CALIBRATION (STATIONARY VEHICLE WITH TARGET)	NEW
A8 [2010] (4H)	STATIC FRONT CAMERA CALIBRATION (STATIONARY VEHICLE WITH TARGET)	NEW
	STATIC FRONT RADAR CALIBRATION (STATIONARY VEHICLE WITH MIRROR)	NEW
Q2 [2016] (GA)	DYNAMIC FRONT RADAR CALIBRATION (MOVING VEHICLE)	NEW
	STATIC FRONT CAMERA CALIBRATION (STATIONARY VEHICLE WITH TARGET)	
	STATIC FRONT RADAR CALIBRATION (STATIONARY VEHICLE WITH MIRROR)	NEW
Q5 [2017] (BY)	STATIC FRONT CAMERA CALIBRATION (STATIONARY VEHICLE WITH TARGET)	
Q7 [2015] (4M)	STATIC FRONT CAMERA CALIBRATION (STATIONARY VEHICLE WITH TARGET)	
	STATIC FRONT RADAR CALIBRATION (STATIONARY VEHICLE WITH MIRROR)	NEW

BMW

1 [2011] (F20)	DYNAMIC FRONT CAMERA CALIBRATION (MOVING VEHICLE)
2 [2014] (F22/F23/F45/F46)	DYNAMIC FRONT CAMERA CALIBRATION (MOVING VEHICLE)
3 [2011] (F30)	DYNAMIC FRONT CAMERA CALIBRATION (MOVING VEHICLE)
4 [2013] (F32)	DYNAMIC FRONT CAMERA CALIBRATION (MOVING VEHICLE)
5 [2007] (E60)	DYNAMIC FRONT CAMERA CALIBRATION (MOVING VEHICLE)
5 [2010] (F10)	DYNAMIC FRONT CAMERA CALIBRATION (MOVING VEHICLE)
5 [2017] (G30)	DYNAMIC FRONT CAMERA CALIBRATION (MOVING VEHICLE)
6 [2003] (E63)	DYNAMIC FRONT CAMERA CALIBRATION (MOVING VEHICLE)
6 [2010] (F06-F12-F13)	DYNAMIC FRONT CAMERA CALIBRATION (MOVING VEHICLE)
6 [2017] (G32)	DYNAMIC FRONT CAMERA CALIBRATION (MOVING VEHICLE)
7 [2009] (F01)	DYNAMIC FRONT CAMERA CALIBRATION (MOVING VEHICLE)
7 [2015] (G11)	DYNAMIC FRONT CAMERA CALIBRATION (MOVING VEHICLE)
I3 [2013] (I01)	DYNAMIC FRONT CAMERA CALIBRATION (MOVING VEHICLE)
I8 [2014] (I12)	DYNAMIC FRONT CAMERA CALIBRATION (MOVING VEHICLE)
X1 [2015] (F48)	DYNAMIC FRONT CAMERA CALIBRATION (MOVING VEHICLE)
X3 [2010] (F25)	DYNAMIC FRONT CAMERA CALIBRATION (MOVING VEHICLE)
X3 [2017] (G01)	DYNAMIC FRONT CAMERA CALIBRATION (MOVING VEHICLE)
X4 [2014] (F26)	DYNAMIC FRONT CAMERA CALIBRATION (MOVING VEHICLE)
X4 [2018] (G02)	DYNAMIC FRONT CAMERA CALIBRATION (MOVING VEHICLE)
X5 [2007] (E70)	DYNAMIC FRONT CAMERA CALIBRATION (MOVING VEHICLE)
X5 [2013] (F15)	DYNAMIC FRONT CAMERA CALIBRATION (MOVING VEHICLE)
X6 [2008] (E71)	DYNAMIC FRONT CAMERA CALIBRATION (MOVING VEHICLE)
X6 [2014] (F16)	DYNAMIC FRONT CAMERA CALIBRATION (MOVING VEHICLE)

2019.Q2 15.06.2019

NEWS AND ANTICIPATIONS

DIAGNOSTIC DATABASE



//@DAS - DIGITAL TECHNOLOGY

CITROEN

C3 [2016] (B61)	DYNAMIC FRONT CAMERA CALIBRATION (MOVING VEHICLE) STATIC FRONT CAMERA CALIBRATION (STATIONARY VEHICLE WITH TARGET)	
C3 AIRCROSS [2017] (A88)	DYNAMIC FRONT CAMERA CALIBRATION (MOVING VEHICLE) STATIC FRONT CAMERA CALIBRATION (STATIONARY VEHICLE WITH TARGET)	
C4 CACTUS [2014]	DYNAMIC FRONT CAMERA CALIBRATION (MOVING VEHICLE) STATIC FRONT CAMERA CALIBRATION (STATIONARY VEHICLE WITH TARGET)	
C4 SPACETOURER [2018]	DYNAMIC FRONT CAMERA CALIBRATION (MOVING VEHICLE) STATIC FRONT CAMERA CALIBRATION (STATIONARY VEHICLE WITH TARGET)	
JUMPY [2016] (K0)	DYNAMIC FRONT CAMERA CALIBRATION (MOVING VEHICLE)	
SPACETOURER [2016] (K0)	DYNAMIC FRONT CAMERA CALIBRATION (MOVING VEHICLE)	

FIAT

500X [2015] (334)	DYNAMIC FRONT RADAR CALIBRATION (MOVING VEHICLE) STATIC FRONT CAMERA CALIBRATION (STATIONARY VEHICLE WITH TARGET)	NEW
-------------------	--	-----

JEEP

RENEGADE [2014] (BU)	DYNAMIC FRONT RADAR CALIBRATION (MOVING VEHICLE) STATIC FRONT CAMERA CALIBRATION (STATIONARY VEHICLE WITH TARGET)	NEW
----------------------	--	-----

LAND ROVER

DISCOVERY SPORT [2014]	DYNAMIC FRONT CAMERA CALIBRATION (MOVING VEHICLE)	
RANGE ROVER EVOQUE [2011]	DYNAMIC FRONT CAMERA CALIBRATION (MOVING VEHICLE)	

MERCEDES

A [2012] (176)	STATIC FRONT CAMERA CALIBRATION (STATIONARY VEHICLE WITH TARGET)	NEW
A [2018] (177)	DYNAMIC FRONT RADAR CALIBRATION (MOVING VEHICLE)	NEW
AMG GT [2018] (X290)	STATIC FRONT CAMERA CALIBRATION (STATIONARY VEHICLE WITH TARGET)	NEW
	DYNAMIC FRONT RADAR CALIBRATION (MOVING VEHICLE)	NEW
	STATIC FRONT CAMERA CALIBRATION (STATIONARY VEHICLE WITH TARGET)	NEW
B [2011] (246)	STATIC FRONT CAMERA CALIBRATION (STATIONARY VEHICLE WITH TARGET)	NEW
B [2019] (247)	DYNAMIC FRONT RADAR CALIBRATION (MOVING VEHICLE)	NEW
	STATIC FRONT CAMERA CALIBRATION (STATIONARY VEHICLE WITH TARGET)	NEW
C [2007] (204)	DYNAMIC FRONT RADAR CALIBRATION (MOVING VEHICLE)	NEW
C [2014] (205)	DYNAMIC FRONT RADAR CALIBRATION (MOVING VEHICLE)	NEW
	STATIC FRONT CAMERA CALIBRATION (STATIONARY VEHICLE WITH TARGET)	NEW
	STATIC FRONT CAMERA CALIBRATION (STATIONARY VEHICLE WITH TARGET)	NEW
CLA [2013] (117)	STATIC FRONT CAMERA CALIBRATION (STATIONARY VEHICLE WITH TARGET)	NEW
CLA [2019] (118)	DYNAMIC FRONT RADAR CALIBRATION (MOVING VEHICLE)	
CLS [2011] (218)	DYNAMIC FRONT RADAR CALIBRATION (MOVING VEHICLE)	NEW
	STATIC FRONT CAMERA CALIBRATION (STATIONARY VEHICLE WITH TARGET)	NEW
CLS [2017] (257)	DYNAMIC FRONT RADAR CALIBRATION (MOVING VEHICLE)	NEW
	STATIC FRONT CAMERA CALIBRATION (STATIONARY VEHICLE WITH TARGET)	NEW

2019.Q2 15.06.2019

NEWS AND ANTICIPATIONS

DIAGNOSTIC DATABASE



//@DAS - DIGITAL TECHNOLOGY

MERCEDES

E [2009] (207)	DYNAMIC FRONT RADAR CALIBRATION (MOVING VEHICLE)	NEW
E [2009] (212)	DYNAMIC FRONT RADAR CALIBRATION (MOVING VEHICLE)	NEW
	STATIC FRONT CAMERA CALIBRATION (STATIONARY VEHICLE WITH TARGET)	NEW
E [2015] (213)	DYNAMIC FRONT RADAR CALIBRATION (MOVING VEHICLE)	NEW
	STATIC FRONT CAMERA CALIBRATION (STATIONARY VEHICLE WITH TARGET)	
GLA [2013] (X156)	STATIC FRONT CAMERA CALIBRATION (STATIONARY VEHICLE WITH TARGET)	NEW
GLC [2015] (X253)	STATIC FRONT CAMERA CALIBRATION (STATIONARY VEHICLE WITH TARGET)	
GLE [2015] (292)	DYNAMIC FRONT RADAR CALIBRATION (MOVING VEHICLE)	NEW
	STATIC FRONT CAMERA CALIBRATION (STATIONARY VEHICLE WITH TARGET)	NEW
ML [2012] (166)	DYNAMIC FRONT RADAR CALIBRATION (MOVING VEHICLE)	NEW
	STATIC FRONT CAMERA CALIBRATION (STATIONARY VEHICLE WITH TARGET)	NEW
ML [2019] (167)	DYNAMIC FRONT RADAR CALIBRATION (MOVING VEHICLE)	
S [2013] (222)	DYNAMIC FRONT RADAR CALIBRATION (MOVING VEHICLE)	NEW
	STATIC FRONT CAMERA CALIBRATION (STATIONARY VEHICLE WITH TARGET)	
S [2014] (217)	DYNAMIC FRONT RADAR CALIBRATION (MOVING VEHICLE)	NEW
	STATIC FRONT CAMERA CALIBRATION (STATIONARY VEHICLE WITH TARGET)	
SL [2011] (231)	DYNAMIC FRONT RADAR CALIBRATION (MOVING VEHICLE)	NEW
SLC [2016] (172)	DYNAMIC FRONT RADAR CALIBRATION (MOVING VEHICLE)	NEW
SPRINTER [2018] (907)	DYNAMIC FRONT RADAR CALIBRATION (MOVING VEHICLE)	NEW
V [2014] (447)	STATIC FRONT CAMERA CALIBRATION (STATIONARY VEHICLE WITH TARGET)	NEW

MINI

CABRIO [2015] (F57)	DYNAMIC FRONT CAMERA CALIBRATION (MOVING VEHICLE)
COUNTRYMAN [2016] (F60)	DYNAMIC FRONT CAMERA CALIBRATION (MOVING VEHICLE)
MINI [2013] (F56)	DYNAMIC FRONT CAMERA CALIBRATION (MOVING VEHICLE)

NISSAN

MICRA [2017] (K14)	STATIC FRONT RADAR CALIBRATION (STATIONARY VEHICLE WITH MIRROR)	NEW
QASHQAI [2013] (J11)	STATIC FRONT CAMERA CALIBRATION (STATIONARY VEHICLE WITH TARGET)	
	STATIC FRONT RADAR CALIBRATION (STATIONARY VEHICLE WITH MIRROR)	NEW

PEUGEOT

3008 [2016]	DYNAMIC FRONT CAMERA CALIBRATION (MOVING VEHICLE)
	STATIC FRONT CAMERA CALIBRATION (STATIONARY VEHICLE WITH TARGET)
308 [2013] (T9)	DYNAMIC FRONT CAMERA CALIBRATION (MOVING VEHICLE)
	STATIC FRONT CAMERA CALIBRATION (STATIONARY VEHICLE WITH TARGET)
5008 [2017]	DYNAMIC FRONT CAMERA CALIBRATION (MOVING VEHICLE)
	STATIC FRONT CAMERA CALIBRATION (STATIONARY VEHICLE WITH TARGET)
EXPERT [2016] (K0)	DYNAMIC FRONT CAMERA CALIBRATION (MOVING VEHICLE)
TRAVELLER [2016] (K0)	DYNAMIC FRONT CAMERA CALIBRATION (MOVING VEHICLE)

2019.Q2 15.06.2019

NEWS AND ANTICIPATIONS

DIAGNOSTIC DATABASE



//@DAS - DIGITAL TECHNOLOGY

RENAULT

ESPACE V [2015] (XFC)	STATIC FRONT CAMERA CALIBRATION (STATIONARY VEHICLE WITH TARGET)	
KADJAR [2015] (XFE)	DYNAMIC FRONT RADAR CALIBRATION (MOVING VEHICLE)	NEW
	STATIC FRONT CAMERA CALIBRATION (STATIONARY VEHICLE WITH TARGET)	
KOLEOS [2017]	DYNAMIC FRONT RADAR CALIBRATION (MOVING VEHICLE)	NEW
MEGANE IV [2016] (XFB)	STATIC FRONT CAMERA CALIBRATION (STATIONARY VEHICLE WITH TARGET)	
SCENIC IV [2016]	STATIC FRONT CAMERA CALIBRATION (STATIONARY VEHICLE WITH TARGET)	
TALISMAN [2015] (XFD)	STATIC FRONT CAMERA CALIBRATION (STATIONARY VEHICLE WITH TARGET)	

SEAT

ARONA [2017] (KJ)	DYNAMIC FRONT RADAR CALIBRATION (MOVING VEHICLE)	NEW
	STATIC FRONT RADAR CALIBRATION (STATIONARY VEHICLE WITH MIRROR)	NEW
ATECA [2016]	DYNAMIC FRONT RADAR CALIBRATION (MOVING VEHICLE)	NEW
	STATIC FRONT CAMERA CALIBRATION (STATIONARY VEHICLE WITH TARGET)	
	STATIC FRONT RADAR CALIBRATION (STATIONARY VEHICLE WITH MIRROR)	NEW
IBIZA [2018] (KJ)	DYNAMIC FRONT RADAR CALIBRATION (MOVING VEHICLE)	NEW
	STATIC FRONT RADAR CALIBRATION (STATIONARY VEHICLE WITH MIRROR)	NEW
LEON [2012] (5F)	STATIC FRONT CAMERA CALIBRATION (STATIONARY VEHICLE WITH TARGET)	
	STATIC FRONT RADAR CALIBRATION (STATIONARY VEHICLE WITH MIRROR)	NEW

SKODA

FABIA [2014] (NJ)	STATIC FRONT RADAR CALIBRATION (STATIONARY VEHICLE WITH MIRROR)	NEW
KAROQ [2017] (NU)	DYNAMIC FRONT RADAR CALIBRATION (MOVING VEHICLE)	NEW
	STATIC FRONT CAMERA CALIBRATION (STATIONARY VEHICLE WITH TARGET)	
	STATIC FRONT RADAR CALIBRATION (STATIONARY VEHICLE WITH MIRROR)	NEW
KODIAQ [2017]	DYNAMIC FRONT RADAR CALIBRATION (MOVING VEHICLE)	NEW
	STATIC FRONT CAMERA CALIBRATION (STATIONARY VEHICLE WITH TARGET)	
	STATIC FRONT RADAR CALIBRATION (STATIONARY VEHICLE WITH MIRROR)	NEW
OCTAVIA [2013] (5E)	STATIC FRONT CAMERA CALIBRATION (STATIONARY VEHICLE WITH TARGET)	
	STATIC FRONT RADAR CALIBRATION (STATIONARY VEHICLE WITH MIRROR)	NEW
SUPERB [2015] (3V)	STATIC FRONT CAMERA CALIBRATION (STATIONARY VEHICLE WITH TARGET)	

TOYOTA

C-HR [2016]	STATIC FRONT CAMERA CALIBRATION (STATIONARY VEHICLE WITH TARGET)	NEW
	STATIC FRONT RADAR CALIBRATION (STATIONARY VEHICLE WITH MIRROR)	NEW
PROACE [2016] (K0)	DYNAMIC FRONT CAMERA CALIBRATION (MOVING VEHICLE)	

VOLKSWAGEN

ARTEON [2017]	STATIC FRONT CAMERA CALIBRATION (STATIONARY VEHICLE WITH TARGET)	
	STATIC FRONT RADAR CALIBRATION (STATIONARY VEHICLE WITH MIRROR)	NEW
GOLF VII [2012] (5G)	STATIC FRONT CAMERA CALIBRATION (STATIONARY VEHICLE WITH TARGET)	
	STATIC FRONT RADAR CALIBRATION (STATIONARY VEHICLE WITH MIRROR)	NEW

2019.Q2 15.06.2019

NEWS AND ANTICIPATIONS

DIAGNOSTIC DATABASE



//@DAS - DIGITAL TECHNOLOGY

VOLKSWAGEN

GOLF VII SPORTSVAN [2014]	STATIC FRONT CAMERA CALIBRATION (STATIONARY VEHICLE WITH TARGET)	
	STATIC FRONT RADAR CALIBRATION (STATIONARY VEHICLE WITH MIRROR)	NEW
PASSAT [2014] (3G)	STATIC FRONT CAMERA CALIBRATION (STATIONARY VEHICLE WITH TARGET)	
POLO [2014] (6C)	STATIC FRONT RADAR CALIBRATION (STATIONARY VEHICLE WITH MIRROR)	NEW
POLO [2018] (AW)	DYNAMIC FRONT RADAR CALIBRATION (MOVING VEHICLE)	NEW
	STATIC FRONT RADAR CALIBRATION (STATIONARY VEHICLE WITH MIRROR)	NEW
SHARAN [2010] (7N)	STATIC FRONT CAMERA CALIBRATION (STATIONARY VEHICLE WITH TARGET)	NEW
TIGUAN [2016] (AD)	DYNAMIC FRONT RADAR CALIBRATION (MOVING VEHICLE)	NEW
	STATIC FRONT CAMERA CALIBRATION (STATIONARY VEHICLE WITH TARGET)	
	STATIC FRONT RADAR CALIBRATION (STATIONARY VEHICLE WITH MIRROR)	NEW
TOURAN [2015]	DYNAMIC FRONT RADAR CALIBRATION (MOVING VEHICLE)	NEW
	STATIC FRONT RADAR CALIBRATION (STATIONARY VEHICLE WITH MIRROR)	NEW
T-ROC [2018] (A1)	DYNAMIC FRONT RADAR CALIBRATION (MOVING VEHICLE)	NEW
	STATIC FRONT CAMERA CALIBRATION (STATIONARY VEHICLE WITH TARGET)	
	STATIC FRONT RADAR CALIBRATION (STATIONARY VEHICLE WITH MIRROR)	NEW

//FORD SPECIALIST

FORD

C-MAX [2015]	EDI (ELECTRONIC DIESEL INJECTION)
	EFI (ELECTRONIC PETROL INJECTION)
FOCUS [2015]	EDI (ELECTRONIC DIESEL INJECTION)
	EFI (ELECTRONIC PETROL INJECTION)
KA+ [2016]	EDI (ELECTRONIC DIESEL INJECTION)

2019.Q2 15.06.2019

NEWS AND ANTICIPATIONS

DIAGNOSTIC DATABASE



// START & STOP

BMW

1 [2011] (F20)

ADATTAMENTO SENSORE POSIZIONE MARCIA IN FOLLE
ATTIVAZIONE E DISATTIVAZIONE FUNZIONE START/STOP
SOSTITUZIONE BATTERIA
START/STOP

CITROEN

BERLINGO 3 [2018] (K9)

START/STOP

C3 AIRCROSS [2017] (A88)

START/STOP

FIAT

DOBLO` [2009] (152)

GEAR NEUTRAL POSITION SENSOR ADAPTATION
START/STOP

DOBLO` CARGO [2009] (263)

GEAR NEUTRAL POSITION SENSOR ADAPTATION
START/STOP

HYUNDAI

I10 [2008] (PA)

START/STOP

JEEP

COMPASS [2016] (MP)

TECHNICAL INFORMATION

KIA

PICANTO [2017]

START/STOP

RIO [2017]

START/STOP

MINI

CABRIO [2015] (F57)

BATTERY REPLACEMENT

START/STOP

START/STOP FUNCTION ACTIVATION AND DEACTIVATION

MINI [2013] (F56)

BATTERY REPLACEMENT

START/STOP

START/STOP FUNCTION ACTIVATION AND DEACTIVATION

2019.Q2 15.06.2019

NEWS AND ANTICIPATIONS

DIAGNOSTIC DATABASE



// START & STOP

NISSAN

NV400 [2011]

START/STOP

OPEL

VIVARO [2014]

START/STOP

PEUGEOT

PARTNER [2018] (K9)

START/STOP

RIFTER [2018]

START/STOP

VAUXHALL

VIVARO [2014]

START/STOP

VOLKSWAGEN

TRANSPORTER T6 [2015]

START/STOP

T-ROC [2018] (A1)

START/STOP

START/STOP FUNCTION ACTIVATION AND DEACTIVATION

// SPECIAL FUNCTIONS

CITROEN

JUMPER [2011]

BODY COMPUTER

FIAT

DUCATO FL [2014] (290)

BODY COMPUTER

PEUGEOT

BOXER [2011]

BODY COMPUTER

2019.Q2 15.06.2019

NEWS AND ANTICIPATIONS

DIAGNOSTIC DATABASE



//ADJUSTMENTS WHAT'S NEW ON REL. 2019.Q2

BMW 1 [2011]

BATTERY REPLACEMENT
EGR VALVE ADAPTATION
GEAR NEUTRAL POSITION SENSOR ADAPTATION
INJECTOR CODING
PARTICULATE FILTER SYSTEM
SELF-LEARNING PARAMETERS RESET

BMW 5 [2017]

BRAKE PADS REPLACING
SERVICE: RESET OF DIESEL MAINTENANCE INDICATOR
SERVICE: RESET OF PETROL MAINTENANCE INDICATOR
SERVICE: SETTING DATA

BMW 6 [2017]

BRAKE PADS REPLACING
SERVICE: RESET OF DIESEL MAINTENANCE INDICATOR
SERVICE: RESET OF PETROL MAINTENANCE INDICATOR
SERVICE: SETTING DATA

BMW 7 [2001]

INJECTOR CODING
PARTICULATE FILTER SYSTEM
SELF-LEARNING PARAMETERS RESET

BMW 7 [2015]

SERVICE: RESET OF DIESEL MAINTENANCE INDICATOR
SERVICE: RESET OF PETROL MAINTENANCE INDICATOR
SERVICE: SETTING DATA

BMW 8 [2018]

SERVICE: RESET OF DIESEL MAINTENANCE INDICATOR
SERVICE: RESET OF PETROL MAINTENANCE INDICATOR

BMW X3 [2017]

BRAKE PADS REPLACING
SERVICE: RESET OF DIESEL MAINTENANCE INDICATOR
SERVICE: RESET OF PETROL MAINTENANCE INDICATOR

BMW X4 [2018]

BRAKE PADS REPLACING
SERVICE: RESET OF DIESEL MAINTENANCE INDICATOR
SERVICE: RESET OF PETROL MAINTENANCE INDICATOR

BMW X5 [2018]

BRAKE PADS REPLACING
SERVICE: RESET OF DIESEL MAINTENANCE INDICATOR
SERVICE: RESET OF PETROL MAINTENANCE INDICATOR

CITROEN BERLINGO 3 [2018]

KEY CODING
REMOTE CONTROL CODING
SERVICE

CITROEN C3 AIRCROSS [2017]

BRAKE PADS REPLACING
KEY CODING
REMOTE CONTROL CODING
SERVICE
STEERING WHEEL ANGLE CALIBRATION

FIAT DOBLO` [2009]

ADDITIVE DIESEL CONTROL / AD BLUE
EGR VALVE ADAPTATION
ENGINE OIL SERVICE RESET
GEAR NEUTRAL POSITION SENSOR ADAPTATION
INJECTOR CODING
PARTICULATE FILTER SYSTEM
SELF-LEARNING PARAMETERS RESET
SERVICE: RESET OF DIESEL MAINTENANCE INDICATOR
THROTTLE VALVE ADAPTATION

FIAT DOBLO` CARGO [2009]

ADDITIVE DIESEL CONTROL / AD BLUE
EGR VALVE ADAPTATION
ENGINE OIL SERVICE RESET
GEAR NEUTRAL POSITION SENSOR ADAPTATION
INJECTOR CODING
PARTICULATE FILTER SYSTEM
SELF-LEARNING PARAMETERS RESET
SERVICE: RESET OF DIESEL MAINTENANCE INDICATOR
THROTTLE VALVE ADAPTATION

FIAT FULLBACK [2016]

SERVICE: SETTING DATA

2019.Q2 15.06.2019

NEWS AND ANTICIPATIONS

DIAGNOSTIC DATABASE



//ADJUSTMENTS WHAT'S NEW ON REL. 2019.Q2

FORD C-MAX [2015]

EGR VALVE ADAPTATION
INJECTOR CODING
PARTICULATE FILTER SYSTEM
SELF-LEARNING PARAMETERS RESET
THROTTLE VALVE ADAPTATION

FORD FOCUS [2015]

EGR VALVE ADAPTATION
INJECTOR CODING
PARTICULATE FILTER SYSTEM
SELF-LEARNING PARAMETERS RESET
THROTTLE VALVE ADAPTATION

FORD KA+ [2016]

INJECTOR CODING
PARTICULATE FILTER SYSTEM
SELF-LEARNING PARAMETERS RESET

HYUNDAI I10 [2008] (PA)

SELF-LEARNING PARAMETERS RESET
THROTTLE VALVE ADAPTATION

KIA PICANTO [2017]

KEY CODING
REMOTE CONTROL CODING
SELF-LEARNING PARAMETERS RESET
SERVICE: RESET OF DIESEL MAINTENANCE INDICATOR
SERVICE: RESET OF PETROL MAINTENANCE INDICATOR
SERVICE: SETTING DATA
STEERING WHEEL ANGLE CALIBRATION
TPMS LEARNING PROCEDURE

KIA RIO [2017]

KEY CODING
REMOTE CONTROL CODING
SELF-LEARNING PARAMETERS RESET
SERVICE: RESET OF DIESEL MAINTENANCE INDICATOR
SERVICE: RESET OF PETROL MAINTENANCE INDICATOR
SERVICE: SETTING DATA
STEERING WHEEL ANGLE CALIBRATION
TPMS LEARNING PROCEDURE

MASERATI GIBLI [2013]

ENGINE OIL SERVICE RESET

MASERATI LEVANTE [2015]

ENGINE OIL SERVICE RESET

MASERATI QUATTROPORTE [2013]

ENGINE OIL SERVICE RESET

MINI CABRIO [2015] (F57)

BATTERY REPLACEMENT
EGR VALVE ADAPTATION
SELF-LEARNING PARAMETERS RESET
THROTTLE VALVE ADAPTATION

MINI MINI [2013] (F56)

BATTERY REPLACEMENT
EGR VALVE ADAPTATION
SELF-LEARNING PARAMETERS RESET
THROTTLE VALVE ADAPTATION

NISSAN NV400 [2011]

BATTERY REPLACEMENT
EGR VALVE ADAPTATION
INJECTOR CODING
PARTICULATE FILTER SYSTEM
SELF-LEARNING PARAMETERS RESET
SERVICE: SETTING DATA
THROTTLE VALVE ADAPTATION
TPMS LEARNING PROCEDURE

OPEL VIVARO [2014]

EGR VALVE ADAPTATION
INJECTOR CODING
PARTICULATE FILTER SYSTEM
SELF-LEARNING PARAMETERS RESET
THROTTLE VALVE ADAPTATION

2019.Q2 15.06.2019

NEWS AND ANTICIPATIONS

DIAGNOSTIC DATABASE



//ADJUSTMENTS WHAT'S NEW ON REL. 2019.Q2

OPEL ZAFIRA B [2005]

SELF-LEARNING PARAMETERS RESET

PEUGEOT 3008 [2009]

REPLACING THE BELT ACCESSORIES
REVERSIBLE ALTERNATOR REPLACEMENT

PEUGEOT 508 [2010]

REPLACING THE BELT ACCESSORIES
REVERSIBLE ALTERNATOR REPLACEMENT

PEUGEOT PARTNER [2018]

KEY CODING
REMOTE CONTROL CODING
SERVICE

PEUGEOT RIFTER [2018]

KEY CODING
REMOTE CONTROL CODING
SERVICE

VAUXHALL VIVARO [2014]

EGR VALVE ADAPTATION
INJECTOR CODING
PARTICULATE FILTER SYSTEM
SELF-LEARNING PARAMETERS RESET
THROTTLE VALVE ADAPTATION

VAUXHALL ZAFIRA B [2005]

SELF-LEARNING PARAMETERS RESET

VOLKSWAGEN CRAFTER [2017]

SERVICE: RESET OF DIESEL MAINTENANCE INDICATOR
SERVICE: RESET OF PETROL MAINTENANCE INDICATOR
SERVICE: SETTING DATA

VOLKSWAGEN POLO [2018]

SERVICE: RESET OF DIESEL MAINTENANCE INDICATOR
SERVICE: RESET OF PETROL MAINTENANCE INDICATOR
SERVICE: SETTING DATA

VOLKSWAGEN TRANSPORTER T6 [2015]

ADDITIVE DIESEL CONTROL / AD BLUE
EGR VALVE ADAPTATION
INJECTOR CODING
PARTICULATE FILTER SYSTEM
SELF-LEARNING PARAMETERS RESET
SERVICE: RESET OF DIESEL MAINTENANCE INDICATOR
SERVICE: RESET OF PETROL MAINTENANCE INDICATOR
SERVICE: SETTING DATA
THROTTLE VALVE ADAPTATION

VOLKSWAGEN T-ROC [2018]

ADDITIVE DIESEL CONTROL / AD BLUE
BRAKE PADS REPLACING
EGR VALVE ADAPTATION
INJECTOR CODING
PARTICULATE FILTER SYSTEM
POWERWINDOWS INITIALIZING
SELF-LEARNING PARAMETERS RESET
SERVICE: RESET OF DIESEL MAINTENANCE INDICATOR
SERVICE: RESET OF PETROL MAINTENANCE INDICATOR
SERVICE: SETTING DATA
STEERING WHEEL ANGLE CALIBRATION
THROTTLE VALVE ADAPTATION
TPMS LEARNING PROCEDURE

2019.Q2 15.06.2019

NEWS AND ANTICIPATIONS

DIAGNOSTIC DATABASE



- FAULTS READING AND ERASURE
- PARAMETERS AND STATUS READING
- ACTIVATIONS
- ADJUSTMENTS

//UPDATE

AUDI

A6 [2011] (4G)
A8 [2010] (4H)
Q7 [2015] (4M)

CAMERA CONTROL MODULE
ADAPTIVE CRUISE CONTROL
CAMERA CONTROL MODULE
ADAPTIVE CRUISE CONTROL



BMW TOP5

1 [2011] (F20)
5 [2017] (G30)
6 [2017] (G32)
7 [2001] (E65)
7 [2015] (G11)
8 [2018] (G15)
X3 [2017] (G01)
X4 [2018] (G02)
X5 [2018] (G05)

EDI (ELECTRONIC DIESEL INJECTION)
SERVICE
SERVICE
EDI (ELECTRONIC DIESEL INJECTION)
SERVICE
SERVICE
SERVICE
SERVICE
SERVICE

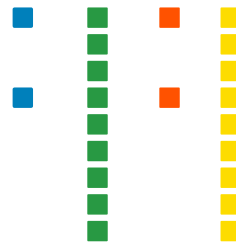

CITROEN

BERLINGO 3 [2018] (K9)
C3 AIRCROSS [2017] (A88)

BODY COMPUTER
ABS
BODY COMPUTER
DASHBOARD
PARKING ASSISTANCE SYSTEM
POWERSTEERING
SRS (AIRBAG)
STEERING CONTROL UNIT



FIAT

500X [2015] (334)
DOBLO` [2009] (152)
DOBLO` CARGO [2009] (263)
FULLBACK [2016]

ADAPTIVE CRUISE CONTROL
EDI (ELECTRONIC DIESEL INJECTION)
EDI (ELECTRONIC DIESEL INJECTION)
DASHBOARD
EDI (ELECTRONIC DIESEL INJECTION)



FORD TOP5

C-MAX [2015]
FOCUS [2015]
KA+ [2016]

EDI (ELECTRONIC DIESEL INJECTION)
EFI (ELECTRONIC PETROL INJECTION)
EDI (ELECTRONIC DIESEL INJECTION)
EFI (ELECTRONIC PETROL INJECTION)
EDI (ELECTRONIC DIESEL INJECTION)



2019.Q2 15.06.2019

NEWS AND ANTICIPATIONS

DIAGNOSTIC DATABASE



- FAULTS READING AND ERASURE
- PARAMETERS AND STATUS READING
- ACTIVATIONS
- ADJUSTMENTS

//UPDATE

HYUNDAI

110 [2008] (PA) EFI (ELECTRONIC PETROL INJECTION) ■ ■ ■ ■

JEEP

RENEGADE [2014] (BU) ADAPTIVE CRUISE CONTROL ■ ■ ■ ■

KIA TOP5

PICANTO [2017]	ABS	■	■	■	■
	BODY COMPUTER	■	■	■	■
	DASHBOARD	■	■	■	■
	EFI (ELECTRONIC PETROL INJECTION)	■	■	■	■
	IMMOBILIZER	■	■		■
	POWERSTEERING	■	■		■
	SRS (AIRBAG)	■	■		■
RIO [2017]	ABS	■	■	■	■
	BODY COMPUTER	■	■	■	■
	CAMERA CONTROL MODULE	■	■		■
	DASHBOARD	■	■	■	■
	EFI (ELECTRONIC PETROL INJECTION)	■	■	■	■
	IMMOBILIZER	■	■		■
	POWERSTEERING	■	■		■
	SRS (AIRBAG)	■	■		■

MASERATI TOP5

GHIBLI [2013]	SERVICE	■	■		■
LEVANTE [2015]	SERVICE	■	■		■
QUATTROPORTE [2013]	SERVICE	■	■		■

MERCEDES BENZ

A [2012] (176)	CAMERA CONTROL MODULE	■	■	■	■
A [2018] (177)	RADAR	■	■	■	■
AMG GT [2014] (C190)	CAMERA CONTROL MODULE	■	■	■	■
AMG GT [2018] (X290)	CAMERA CONTROL MODULE	■	■	■	■
	RADAR	■	■	■	■
B [2011] (246)	CAMERA CONTROL MODULE	■	■	■	■
B [2019] (247)	CAMERA CONTROL MODULE	■	■	■	■

2019.Q2 15.06.2019

NEWS AND ANTICIPATIONS

DIAGNOSTIC DATABASE



- FAULTS READING AND ERASURE
- PARAMETERS AND STATUS READING
- ACTIVATIONS
- ADJUSTMENTS

//UPDATE

MERCEDES BENZ

C [2007] (204)	RADAR	■	■	■	■
C [2014] (205)	RADAR	■	■	■	■
CLA [2013] (117)	CAMERA CONTROL MODULE	■	■	■	■
CLS [2011] (218)	CAMERA CONTROL MODULE	■	■	■	■
	RADAR	■	■	■	■
CLS [2017] (257)	RADAR	■	■	■	■
E [2009] (207)	RADAR	■	■	■	■
E [2009] (212)	CAMERA CONTROL MODULE	■	■	■	■
	RADAR	■	■	■	■
E [2015] (213)	RADAR	■	■	■	■
GLA [2013] (X156)	CAMERA CONTROL MODULE	■	■	■	■
GLE [2015] (292)	CAMERA CONTROL MODULE	■	■	■	■
	RADAR	■	■	■	■
ML [2012] (166)	RADAR	■	■	■	■
S [2013] (222)	RADAR	■	■	■	■
S [2014] (217)	RADAR	■	■	■	■
SL [2011] (231)	RADAR	■	■	■	■
SLC [2016] (172)	RADAR	■	■	■	■
SPRINTER [2018] (907)	RADAR	■	■	■	■

MINI

CABRIO [2015] (F57)	EFI (ELECTRONIC PETROL INJECTION)	■	■	■	■
MINI [2013] (F56)	EFI (ELECTRONIC PETROL INJECTION)	■	■	■	■

MITSUBISHI

COLT [2004]	EDI (ELECTRONIC DIESEL INJECTION)	■	■	■	■
-------------	-----------------------------------	-------------------------------------	--------------------------------------	---------------------------------------	---------------------------------------

NISSAN

LEAF [2011] (ZE0)	AIR CONDITIONING	■	■	■	■
MICRA [2017] (K14)	RADAR	■	■	■	■
NV350 [2011]	EDI (ELECTRONIC DIESEL INJECTION)	■	■	■	■
NV400 [2011]	ABS	■	■	■	■
	ANTI-THEFT SYSTEM	■	■	■	■
	BODY COMPUTER	■	■	■	■
	DASHBOARD	■	■	■	■
	EDI (ELECTRONIC DIESEL INJECTION)	■	■	■	■
	MULTIMEDIA SYSTEMS	■	■	■	■
	SRS (AIRBAG)	■	■	■	■
	UNDERHOOD ELECTRICAL MODULE	■	■	■	■
QASHQAI [2013] (J11)	RADAR	■	■	■	■

2019.Q2 15.06.2019

NEWS AND ANTICIPATIONS

DIAGNOSTIC DATABASE



- FAULTS READING AND ERASURE
- PARAMETERS AND STATUS READING
- ACTIVATIONS
- ADJUSTMENTS

//UPDATE

OPEL

VIVARO [2014]
ZAFIRA B [2005]

EDI (ELECTRONIC DIESEL INJECTION)
EFI (ELECTRONIC PETROL INJECTION)



PEUGEOT TOP5

3008 [2009] (T8)

BATTERY CONTROL SYSTEM
HYBRID CONTROL SYSTEM

308 [2013] (T9)

AUTOMATIC GEARBOX
EDI (ELECTRONIC DIESEL INJECTION)

508 [2010] (W2)

BATTERY CONTROL SYSTEM
HYBRID CONTROL SYSTEM

PARTNER [2018] (K9)
RIFTER [2018]

BODY COMPUTER
BODY COMPUTER



RENAULT

KADJAR [2015] (XFE)
KOLEOS [2017]

RADAR
CAMERA CONTROL MODULE
RADAR



TOYOTA

C-HR [2016]

CAMERA CONTROL MODULE



VAUXHALL

VIVARO [2014]
ZAFIRA B [2005]

EDI (ELECTRONIC DIESEL INJECTION)
EFI (ELECTRONIC PETROL INJECTION)



VOLKSWAGEN

CRAFTER [2017]

DASHBOARD

GOLF VII [2012] (5G)

LIGHTS SYSTEM

PASSAT [2014] (3G)

LIGHTS SYSTEM

POLO [2018] (AW)

DASHBOARD

SHARAN [2010] (7N)

CAMERA CONTROL MODULE

TRANSPORTER T6 [2015]

EDI (ELECTRONIC DIESEL INJECTION)



2019.Q2 15.06.2019

NEWS AND ANTICIPATIONS

DIAGNOSTIC DATABASE



- FAULTS READING AND ERASURE
- PARAMETERS AND STATUS READING
- ACTIVATIONS
- ADJUSTMENTS

//UPDATE

VOLKSWAGEN

T-ROC [2018] (A1)

- ABS
- ADAPTIVE CRUISE CONTROL
- AIR CONDITIONING
- CENTRAL GATEWAY
- DASHBOARD
- DOORS SYSTEM
- EDI (ELECTRONIC DIESEL INJECTION)
- ELECTRONIC CENTRAL ELECTRICS SYSTEM
- PARKING ASSISTANCE SYSTEM
- POWERSTEERING
- STEERING CONTROL UNIT



VOLVO TOP5

V60 [2010]

- BATTERY CONTROL SYSTEM
- CHARGER SYSTEM
- HYBRID CONTROL SYSTEM

